



Lille 2023



Content: Veronica Sforzin, Federica Innocenti, Davide Succi, Walter Zara
Editing & Layout & Management: Francesco Falcone - Project Management: Andrew Heckt

<https://legacyeuropeantour.com/event/lec-lille/>
<https://legacyeuropeantour.com/>

INTRODUCING LILLE



Lille is a former medieval capital of Flanders with an industrial history that transformed it into an art and cultural city in the 1990s. Today it has a large university population and known as a cultural hub. The city center maintains much of its 17th century architecture.



THE VENUE

GENERAL INFORMATION

REACHING THE VENUE

<https://legacyeuropentour.com/event/lec-lille/>



SEP 29th – OCT 1st

REACHING THE VENUE

— — —

Lille Grand Palais is well connected by public transportation, with several different options to choose from.

If you are coming by train, **Lille Gare d'Europe** and **Lille Flandres** are both just a 10 minutes walk from the Venue.

They are both served as well by the Lille Metro line, although there are closer **metro stations** such as **Lille Town Hall** and of course **Lille Grand Palais** itself

You can also arrive by bus, taking the **Citadine 1 Line** up to the **Zenith** stop



GENERAL INFORMATION

Lille Grand Palais is a complex located in the heart of the Lille Metropolis. Designed by the Dutch architect Rem Koolhaas with Cecil Balmond and inaugurated in 1994, it brings together three complementary spaces: a Congress Centre, Exhibition Halls and a Zenith Arena

Lille Grand Palais is located at
1, Boulevard des Cites-Unies
59777 EURALILLE LILLE, FRANCE

For Info: Grand Palais Home

<https://www.lillegrandpalais.co.uk/lillegrandpalais/>

Google maps position:

<https://goo.gl/maps/Wy3izaUhtEW9cUBk9>



THINGS TO KNOW



GENERAL INFORMATION



LANGUAGE



MONEY



WEATHER



ELECTRICITY AND PLUGS



OTHER INFORMATION



— — —



GENERAL INFORMATION

Telephone country code: +33

Emergency numbers:

- Call (+33) 112 for **life threatening emergencies** and ask for the police, fire department or ambulance service. This is a EU-wide general emergency number.

Specific numbers are:

- (+33) 15 for **ambulance service**
- (+33) 17 for **police**
- (+33) 18 for **fire department**

Time zone during summer: Central European Summer Time (CEST), UTC+2

Time and date format: 24-hour clock (0:00 – 23:59), dd/mm/yy (or yyyy)



LANGUAGE

The official language in Lille is French🇫🇷. The accent is known to be different from the French you will have learned in an international school.

English🇬🇧 is spoken a little and most restaurants and tourist places are likely to have a menu or english displayed.



USEFUL PHRASES



Do you speak English?

Thank you

Please

You're welcome

Can you repeat?

What's your name?

Yes

No

Can you help me?

Is the tip included?

Excuse me

Parlez-vous anglais?

Merci/Merci beaucoup

S'il vous plaît

Merci/Merci beaucoup

Répétez, s'il vous plait?

Comment t'appelles-tu?

Oui

Non

Pourriez-vous m'aider?

Est-ce que le pourboire est inclus?

Excuse-moi

USEFUL PHRASES



How much does it cost?

Combien ça coûte?

I'm sorry

Je suis désolé

Can I get on the Internet?

Puis-je accéder à Internet ?

I don't understand

Je ne comprends pas

I don't speak French

Je ne parle pas français

Can you help me?

Pouvez-vous m'aider?

Where is the bathroom?

Où se trouvent les toilettes?

Can you speak slowly?

Peux-tu parler lentement?

NUMBERS

1 \ un

2 \ deux

3 \ trois

4 \ quatre

5 \ cinq

6 \ six

7 \ sept

8 \ huit

9 \ neuf

10 \ dix

100 \ cent

1000 \ mille



MONEY

France is part of the European Union, and its currency is the **Euro (EUR - €)**. You can pay with credit cards almost everywhere.

You will find places to exchange at transportation hubs and with your hotel. Rates vary and often are better the further away from a major hub you are.





WEATHER

Lille begins to cool from its summer temperatures in late September and high temperatures will 15 °C (59F) and lows approaching 8 °C (46F).

The end of September tends to see some rainy days, with an average of one in four rainy days.

We recommend dressing in layers and bringing at least some waterproof equipment





ELECTRICITY VOLTAGE AND PLUGS

In France the power plugs and sockets are of type C and E. The standard voltage is 230 V and the standard frequency is 50 Hz.

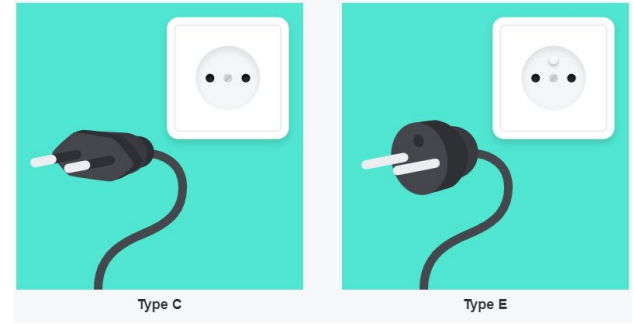

If your devices are made only for 100V and 127V (such as in the US, Canada and most South American countries) you **cannot use them** and you will need a **voltage converter**.





OTHER INFORMATION

The usual opening hours for stores in the centre are continuous (**9:30 a.m.- 8:00 p.m.**). Some shops and restaurants close on Sunday, so check your destination.

Tap water is safe to drink in Lille and is constantly monitored by government authorities

ARRIVING TO THE CITY

BY PLANE
BY TRAIN
BY BOAT



BY PLANE



— — —

The Lille-Lesquin International Airport (LIL) is located 10 km from Lille city centre. It serves more than 70 national and international destinations.

A 20 minutes long shuttle service from the airport to the city centre is available (bus stop sign "Liaison aéroport" in front of the Euralille shopping centre).

<https://www.flibco.com/en/shuttle/bus-lille-airport>

Another popular option is Bruxelles Charleroi (CRL), which is well connected by bus to the city of Lille



BY TRAIN

— — —

Situated just 500 metres from one another, Lille's two train stations are located in the city centre and are served by both the subway and the tram.

Lille Flandres Station is served by TER regional trains and direct TGV service to Paris, while Lille Europe Station provides Eurostar service to London and Brussels, direct TGV service to Roissy Airport, Paris and all major French cities.

Both stations are also quite close to the venue



BY BUS

BlablaBus (formerly OuiBus) and Flixbus offer regular routes to Lille.

Travelling by bus is often an economical yet comfortable option. Buses are usually equipped with wide and comfortable seats, toilets, Wi-Fi and electrical outlets.

For example if you are travelling from the south of Europe one of the best options is to land in Charleroi Airpot in Bruxelles and take a BUS to Lille.

The bus station is located next to the Lille Europe station in the centre of Lille.



GETTING AROUND Lille

PUBLIC TRANSPORTATION

METRO

BUS & TRAM

TAXI



PUBLIC TRANSPORTATION

Operated by ilevia, Lille has a comprehensive public transport network, consisting of two automatic metro lines (the VAL: automatic light vehicle), two tram lines and about 60 bus routes, all running every day.

Standard (single) fare for the entire network is 1.80€ for a full-price single ticket, with sets of 10 tickets available for 15.40€.

Other options include:

- ZAP ticket (3 tram or subway stations, transfert available): €1.15
- Day Pass (lasting 24h): €5.30
- Evening Pass (after 7.00 pm): €2.45

The buses, trams and metros are free with City Pass.

For more information call +33 (0)3 20 40 40 40 or visit www.ilevia.fr



METRO AND TRAMWAY



The Lille metro is fast, comfortable and accessible. It is the world's first automatic metro, and also the one with the highest frequency.

Its network spans 60 stations and connects to the airport via a bus shuttle. It works everyday from 5 am until midnight.

The Lille tramway, also known as the Grand Boulevard or "Mongy" tramway, went into service in 1909. Designed by Alfred Mongy, the Lille tramway's Y-shaped layout linked the Gare Lille Flandres with the towns of Roubaix and Tourcoing, passing through La Madeleine, Marcq-en-Barœul, Wasquehal, Villeneuve-d'Ascq, Croix and Mouvaux.

The Lille tramway has two lines:

Line R: Lille => Roubaix Eurotéléport

T line: Lille => Tourcoing Centre

TRAMWAY

— — —

The Lille tramway, also known as the Grand Boulevard or "Mongy" tramway, went into service in 1909. Designed by Alfred Mongy, the Lille tramway's Y-shaped layout linked the Gare Lille Flandres with the towns of Roubaix and Tourcoing, passing through La Madeleine, Marcq-en-Barœul, Wasquehal, Villeneuve-d'Ascq, Croix and Mouvaux.

The Lille tramway has two lines:

Line R: Lille => Roubaix Eurotéléport

T line: Lille => Tourcoing Centre

These two lines have a common trunk between Lille and Croisé Laroche in Marcq-en-Barœul.

The Lille metropolitan area streetcar is a fast and pleasant way to get around!



TAXIS & UBER

Convenient yet rather expensive, getting around Lille by taxicab is not your best option if you're on a budget.

The basic fee is €7.00, the kilometer price is €1.90. Night time (from 10:00pm until 6:00am) and Sunday all day the basic fee raises to €2.00 and the kilometer price is €2.44

A few taxi companies you can call:

- Taxis Lille Flandres (+33 (0)7 60 06 61 61),
- Taxis Lille Métropole (+33 (0)6 62 32 49 24)
- Taxi Union Lille (+33 (0)3 20 06 06 06)

You can also easily find taxi lines in front of hotels and main attractions. It's easy to hail one on the street.

Uber is the main ride-sharing app used in Lille. Uber rates are slightly cheaper than standard taxicabs.



TOURIST ATTRACTIONS

Grand'Place
Palais des Beaux Arts
Vieille Bourse
Vieux-Lille district
Parc de la Citadelle



Grand'Place

Nicknamed Grand Place, the square named after General de Gaulle is located northeast of the center of Lille.

The square is bordered by an interesting combination of ancient and modern architecture and is one of the main meeting places in the city. It covers almost 10,000 square meters and in the center houses one of the most important monuments of Lille: the fountain with the Column of the Goddess.

Take advantage of the beautiful days to relax with a beer and watch the people go by in the outdoor areas of the bars and restaurants.



Palais des Beaux Arts

A luxurious Belle Époque building built in 1892, the Palais des Beaux-Arts de Lille houses an impressive collection of paintings, sculptures and drawings from antiquity to the contemporary age.

It is one of the largest art museums in France and houses masterpieces by Jacques-Louis David, Pablo Picasso and Eugène Delacroix. The entrance ticket costs a few euros and includes the audio guide.

Opening Hours: Wednesday to Sunday 10am to 6pm, Monday 2pm to 6pm, closed on Tuesdays

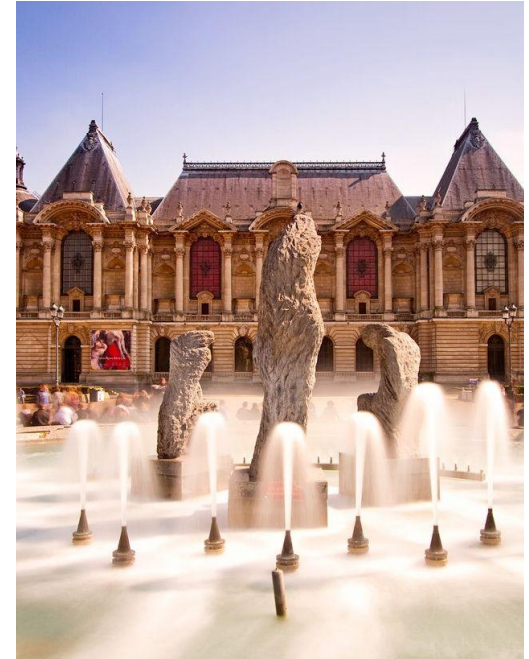

Vieille Bourse

The Vieille Bourse is one of the main monuments of the city of Lille. The complex consists of twenty-four lots built to enclose an internal porticoed courtyard and is a splendid example of 17th-century architecture in the typical style of the Flemish Renaissance. The Old Stock Exchange is a national historic monument, but at the same time it is a lively place where you can find a used book market, stalls of flower sellers and tables for playing chess.

**Opening hours: Tuesday to Sunday from 13:00 to 19:00,
Closed on Mondays**



Vieux-Lille district

The Old-Lille district is enclosed within a radius of about one kilometer from the Grand Place.

Alongside beautifully restored brick and stone houses, some dating back to the 17th century, the neighborhood is home to many monuments, including the Old Stock Exchange building, the Opera House and the birthplace of Charles de Gaulle.

The alleys are filled with restaurants, boutiques and lively estaminets, small traditional bars typical of northern France.



Parc de la Citadelle

The Parc de la Citadelle is a 60-hectare island formed by the Canal de la Deûle. Located east of the Old Town, it is the largest green space in the city.

Here you will find important monuments and attractions, including the Citadel of Lille, the Vauban Garden, the Zoo, the Bois de Boulogne and the Cita-Parc, a small amusement park. There are also stalls in the park selling snacks and drinks.

Opening hours: The park is always accessible. The Zoo is open Wednesday to Monday from 10am to 5pm in winter and 10am to 6pm in summer (closes at 7pm on weekends); it is closed on Tuesdays.



SPECIAL EVENTS IN THE WEEKEND OF THE LEC

Rugby World Cup 2023

Tidy up your room!
(exhibition)



Rugby World Cup 2023

WHERE: Stade Pierre Mauroy

WHEN: 8 September 2023 - 28 October 2023

This year, France has been selected to host the Rugby World Cup 2023. Come and discover the world of rugby through five matches to be played in Lille's stadiums.

The Rugby World Cup is one of the most prestigious events in the sporting world, attracting millions of spectators from all over the world. It's a unique opportunity to bring together rugby enthusiasts to experience moments of sharing, emotion and excitement.

Supporters will be able to enjoy the warm hospitality of the people of Lille and discover the charm of the metropolitan area through its rich and varied programme

More info at: <https://hellolille.eu/en/rugby23/>



LILLE
STADE PIERRE MAUROY

A	FRANCE - URUGUAY Jeudi 14 septembre - 21h
D	ANGLETERRE - CHILI Samedi 23 septembre - 17h45
B	ÉCOSSE - ROUMANIE Samedi 30 septembre - 21h
D	ANGLETERRE - SAMOA Samedi 7 octobre - 17h45
B	TONGA - ROUMANIE Dimanche 8 octobre - 17h45

Tidy up your room! Jean François Fourtou

WHERE: 17 Boulevard Jean-Baptiste Lebas

WHEN: 12 April 2023 - 8 October 2023 (Wed-Sun 12:00 to 19:00)

For this 2023 season, the Gare Saint Sauveur is hosting an exhibition that will delight young and old alike.

In this exhibition, Jean-François Fourtou presents his first childhood bedroom, which he occupied until he was four years old, in the family flat in the heart of the old working-class district of Paris: Ménilmontant.

The artist invites the visitor to return to the magical world of childhood, to lose his adult bearings for a time in a monumental children's room, six times larger and more disordered, emerging incongruously and spectacularly from the concrete skeleton of the station!

More info at:

<https://en.lilletourism.com/tidy-up-your-room-jean-francois-fourtou-gare-st-sauveur.html>



WHAT NOT TO MISS IN THE CITY

Shopping in Lille

Food and Restaurants

Lille by Night



Shopping in Lille

Lille Old Town (Le Vieux Lille)

Lille Old Town is the historic district of the city with buildings that are hundreds of years old, many of them containing small, independent boutique shops. The shops here are as charming and quaint as the district itself, including everything from high-end clothing boutiques to small arts and crafts stores and independent art galleries.



Shopping in Lille

Marché de Wazemmes

Marché de Wazemmes is a beloved covered market that draws hundreds of locals to the working-class quarter of Lille every week with arts, crafts and food stalls. Here you can find 26 vendors tucked under a roof less than 5 minutes south-west of the city centre and about a mile from the tourism centre. Outside the cover, 3 times a week, the market explodes in size with up to 400 additional vendors selling everything from food to clothes, bric-a-brac, arts and crafts, adding to the excitement and buzz.



Shopping in Lille

Fashion District - Avenue Jean-Lebas in Roubaix

The Fashion District along Avenue Jean-Lebas in Roubaix offers the chance to shop all of the latest local, national and international haute couture brands. Many stores here are dedicated to hot, up-and-coming young designers offering fashions that are truly avant-garde and unique. If you want to find clothes that might well be the next wave in fashion and grab them before they become the hot item, this is where you can go to find them. Even better, it's steps from local museums and galleries where you can show off your new clothes.



Food and Restaurants - Le Welsh



Le Welsh is a dish made from boiling beer and cheese, poured over toast and ham, cooked at high temperature until golden brown, topped with a fried egg. In other areas of the world, it's called 'Welsh rarebit', but the version in Flemish cooking is a bit different with ham and beer, and each restaurant adds its own special touch with ingredients like mustard.

Le Welsh is such a popular staple of Northern French cuisine that it's served up with Belgian fries in most restaurants, and it's worth taking a Welsh tour just to sample it in many spots. Some of the best in Lille include the Ilot Bar, Cysoing and Georges V.

Where to find:

La Pâte Brisée, 65 Rue de la Monnaie

<https://www.restaurant-lapatebriseelille.fr/>

Food and Restaurants - La Tarte au Maroilles

La tarte au Maroilles originally hails from Thiérache and l'Avesnois, and bakes cubes of Maroilles cheese in a shortcrust pastry with crème fraîche, butter, salt, pepper and eggs. Of course, variants abound for this simple quiche-like dish, which is believed to have Flemish roots that date back hundreds of years. It's meant to be enjoyed warm and is generally paired with Belgian fries, salad and a glass of red or white wine or beer.

Where to find:

La Pâte Brisée, 65 Rue de la Monnaie

<https://www.restaurant-lapatebriseelille.fr/>



Food and Restaurants - La Carbonade Flamande



La carbonade flamande is a type of Flemish beef stew that is without a doubt one of the signature dishes of Lille, with every restaurant having its own delicious take. For the most part, carbonade flamande is made of beef, onion, sugar, beer, mustard, salt, vinegar and various herbs and spices cooked with baked lard and served with homemade bread. The specific mix of ingredients means that the flavour can significantly differ everywhere you try it.

Where

Estaminet Au Vieux De La Vieille, 2 Rue des Vieux Murs
<https://estaminetlille.fr/>

to

find:

Food and Restaurants - Les Moules-Frites

Les moules-frites is a popular and historic main dish of mussels and Belgian fries that originated in Belgium hundreds of years ago and is highly popular in Lille. This national dish of Belgium is a prime example of the influence of the Flemish tradition on the culinary styling of the region. The most common variety sees the mussels cooked in white wine, shallots, butter and parsley, but tons of variants exist, some of which even feature raw mussels on the half-shell.

Where to find:

Aux Moules de Lille, 11 Pl. Rihour

<https://www.auxmoulesdelille.fr/>



Food and Restaurants - Le Potjevleesch/Le Potch



Le Potjevleesch, or Le Potch, is a Flemish culinary speciality that simply translates to "pot of meat" and consists of cuts of various meats marinated and served with vinegar gelatin. Because the meat used can include anything from pork to beef to veal to rabbit to chicken and beyond, the flavour can change with every location. What is usually common is that the meat is marinated and cooked together in beer or white wine with candied spices, cooled, and then served in a terrine with vinegar gelatin. It's often served with slaw and Belgian fries on the side.

Where to find:
L'Estaminet Le Rijsel, 25 Rue de Gand
<https://estaminet-rijsel.fr/fr>

Food and Restaurants - Merveilleux



The Merveilleux are a typical dessert of Belgium and Northern France, composed, in the most classic version, of a double layer of meringue, filled and covered with whipped cream and chocolate flakes. Soft, light, gluten-free, aesthetically inviting and available in various sizes, from pastry to cake, for many French people this dessert represents a visceral childhood memory linked to family and Sunday lunches

Where to find:

Aux Merveilleux de Fred, Lille Flandres station 1 Place des Buisser
<https://auxmerveilleux.com/en/6-merveilleux>

Food and restaurants - Gaufre lilloise (à la vergeoise)

Sweet wafer-like and oval-shaped, soft and thin are filled with vanilla cream or ice cream and fresh fruits or with a sugar paste called vergeoise and rum. The light pastry is similar to the waffle one, but more crispy and delicately browned. They're a speciality of Northern French cooking, and the vergeoise is a filling made of sugar, rum and butter that offers an unbelievably rich and delectable flavour that's sure to keep you coming back for more.

Where **to** **find:**

Meert, 25-27 Rue Esquermoise

<https://www.meert.fr/>



Other Suggested Restaurants near the Venue

Pancook Lille Zénit

2 Av. du Président Hoover (4 minutes walk from the venue)

Opening hours: mon-wed (12-14), thu (12-14/18:30-23), fri (12-14/18-22:30), sat (18-23), closed on sunday

Description: Friendly atmosphere, traditional cuisine revisited. The Pancook welcomes you in a pleasant and friendly setting. For your lunches and dinners, they provide a brasserie-restaurant service with an à la carte menu prepared by their chef. The specialty of their establishment is the pancook, a loaf of bread emptied of its crumb to add a homemade preparation based on meat, chicken or fish and vegetables in cream.

More info at: <https://pancook.fr/reservation-pancook-lille-zenith/>



Other Suggested Restaurants near the Venue

Un coin de paradis,

24 Rue Paul Duez (3 minutes walk from the venue)

Opening hours: monday-friday (10:30-19), closed on sat and sun

Description: Estaminet where you can enjoy eating just before a concert at the Zénith or an exhibition at the Grand Palais. Professional and fast service, the atmosphere is welcoming, without confusion. Short menu but homemade and good.

More infos: <https://www.facebook.com/uncoindeparadis.24>



Lille by Night - Bars and pubs

— — —

Lille bars and pubs can be found all over the city and offer you the classic corner bar nightlife experience to have a few drinks and toast your friends. Bars of just about every variety can be found in Lille, whether you're looking for a 1920s speakeasy-style vibe, a small dive bar experience or a classically elegant cocktail bar.

You'll find bars for the older crowd, with dark wood furnishings and dim lighting, as well as vibrant hipster outlets with bright lights and modern music, sometimes from live bands. Some of the popular local bars include Le Dandy on Rue Basse, Le Windsor in the city centre, Le Bar Braz on Rue Doudin and Stairway on Rue de la Halle.



Lille by Night - Casinos

— — —

Lille casinos offer the chance to have it all in one spot, with gaming, great drinks, food and live entertainment of just about every variety all across town. You can experience everything from standalone gaming parlours in the heart of the city centre to full-featured leisure complexes combined with all-inclusive 5-star hotels and everything in between. Casinos stand in the heart of the urban jungle and on the shores of the North Sea with spectacular views. You can play roulette, table games and slots and even engage in sports betting.

Each casino has its own theme and vibe, but all are wildly fun. Some of the more popular include Napoléon Games Middelkerke and Casino Barrière near the train station.



Lille by Night - Nightclubs

— — —

Nightclubs in Lille showcase the vibrant and youthful vibe of this university town, from DJs spinning the latest EDM music to live local bands jamming all night. You can hit up clubs like Stairway in the heart of the historic city centre for draught beers and cocktails with live rock bands. You can dive into superb Latin music and salsa dancing at Latina Café in the city centre. You can hit up Les Folie's in Old Town or Magazine Club in Moulines to enjoy the latest popular dance hits spun by popular DJs.

Whatever your nightclub vibe might be, Lille has it on offer. The city centre and the historic Vieux Lille are both dotted with vibrant clubs to explore.



Lille by Night - La Vieille Bourse

La Vieille Bourse is the old stock exchange in Lille, one of the most historically stunning buildings in the entire city, offering a peaceful and scenic spot to enjoy an evening. The spot dates to the middle of the 17th century and consists of 24 houses in classic Flemish design surrounding a lovely arcaded courtyard. Designed by a furniture builder named Julien Destrée, this spot has been a fixture of Lille's social life for 350 years.

People come to sit and play chess, talk or explore the flower and book market that is here every day. During the summertime, you can watch live dance performances at no cost. It's only about 10 minutes from the heart of the city centre.

Where: Pl. du Général de Gaulle

Opening hours: Tue-Sun from 1 pm to 7 pm (closed on Mondays)

Tel.: +33 3 59 57 94 00

